

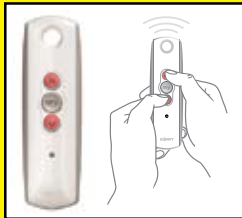

Somfy Motor Programming

These programming instructions **MUST BE FOLLOWED IN SEQUENTIAL ORDER**



Step 1

Ensure that there is power going only to the motor you want to program.
If using a T4 select appropriate channel.
Press and hold the **Up & Down** buttons together and release them when the motor jogs



Step 2

Check that the down button is taking the unit out or down. If it proceed to Step #3. If it is not Press & Hold the **My** (stop) button and release it when the motor jogs

Altus RTS

or

Sunea RTS CMO

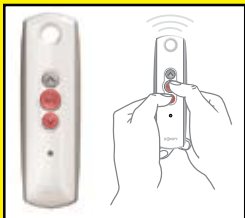

Step 3

Press & Hold the **Down & My** (stop) button and release them when the unit starts to move out or down

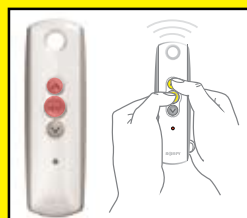

Step 3

Press & Hold **Down** button until awning moves automatically - **Stop** at outside limit Press & Hold the **Up & My** (stop) button and release them when the unit starts to move in or up

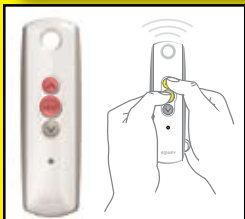

Step 4

Press & Hold the **Up & My** (stop) button and release them when the unit starts to move in or up

Step 4

Stop the unit 1/2



Step 5

Press & Hold the **My** (stop) button until unit jogs (Altus RTS) or moves in (Sunea RTS CMO)

Adjust Limits

Send unit to current limit either **all the way out or in**

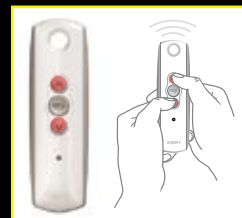

Step 1

Press & Hold **Up & Down** button together release when motor jogs



Step 6

Press & Hold the **Programming** button on back of remote, release it when motor jogs



Step 2

Move to new position and Press & Hold **My** (stop) button, release when motor jogs